

FRAME AND GRATE

SEE STANDARD PLANS 5-4 THRU 5-9 AND 5-12

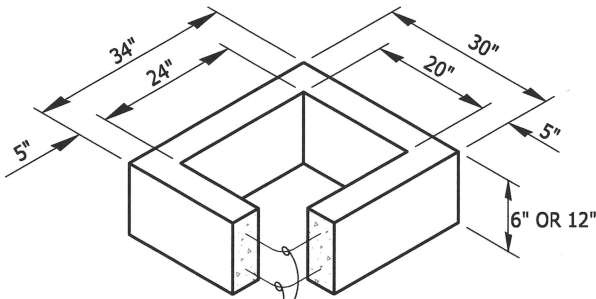

ONE #3 BAR HOOP FOR 6" HEIGHT
TWO #3 BAR HOOPS FOR 12" HEIGHT

6" WEIGHS 200 LBS.
12" WEIGHS 580 LBS.

RECTANGULAR ADJUSTMENT SECTION

STATION AND OFFSET POINT WHEN DESIGN AND LAYOUT PROVIDED BY THE CITY OF KENT, UNLESS OTHERWISE NOTED ON THE PLANS

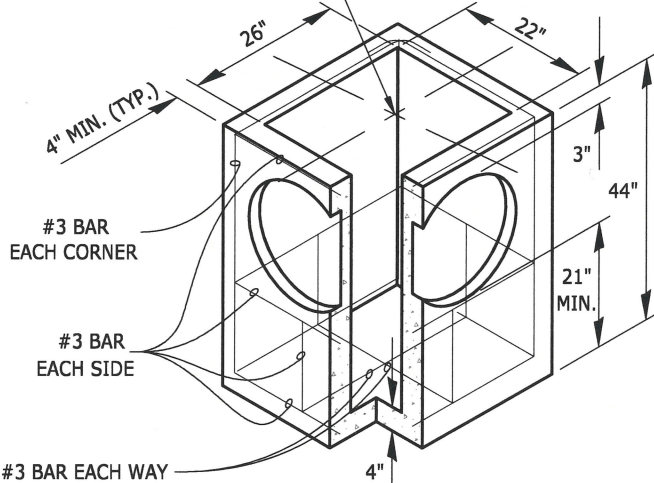

PRECAST BASE SECTION
(WEIGHS 2170 LBS.)

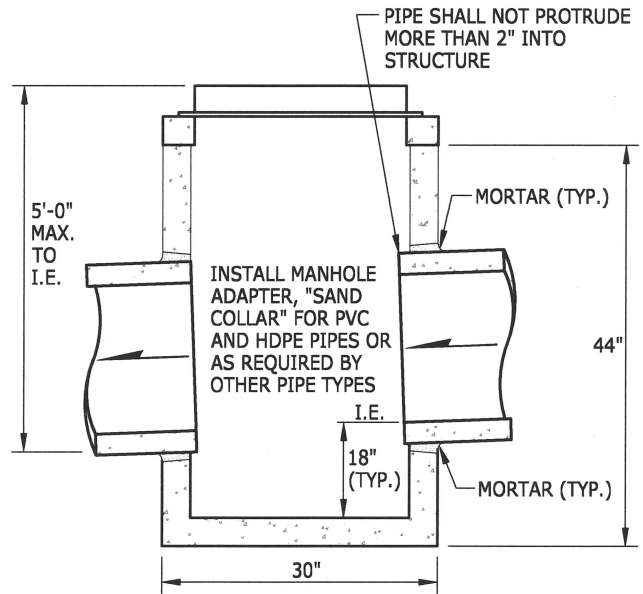

TYPICAL SECTION

NOTES:

1. CATCH BASIN TO BE CONSTRUCTED IN ACCORDANCE WITH AASHTO M 199, (ASTM C 478, & ASTM C 890) UNLESS OTHERWISE SHOWN ON PLANS OR NOTED IN THE WSDOT STANDARD SPECIFICATIONS.
2. AS AN ACCEPTABLE ALTERNATE TO REBAR, WELDED WIRE FABRIC HAVING A MINIMUM AREA OF 0.12 SQUARE INCHES PER FOOT MAY BE USED. WELDED WIRE FABRIC SHALL COMPLY TO AASHTO M 221 (ASTM A 1064). WIRE FABRIC SHALL NOT BE PLACED IN THE KNOCKOUTS.
3. PRECAST BASES SHALL BE FURNISHED WITH CUTOUTS OR KNOCKOUTS. THE KNOCKOUT DIAMETER SHALL NOT EXCEED 20". KNOCKOUTS SHALL HAVE A WALL THICKNESS OF 2" MINIMUM. PROVIDE A 1.5" MINIMUM GAP BETWEEN THE KNOCKOUT WALL AND THE OUTSIDE OF THE PIPE.
4. ALL JOINTS IN THE BRICKS, GRADE RINGS, RISERS AND CASTINGS SHALL BE SEATED IN MORTAR. PICK HOLES, CRACKS AND ANY OTHER JOINTS SHALL BE FINISH GROUTED TO PROVIDE A WATERTIGHT STRUCTURE.
5. THE MAXIMUM DEPTH FROM THE FINISHED GRADE TO THE LOWEST PIPE INVERT SHALL BE 5 FEET. DEPTHS GREATER THAN 5 FEET REQUIRE UPSIZING TO A TYPE II STRUCTURE.
6. NON-CEMENTITIOUS MATERIALS ARE NOT ALLOWED IN SETTING OF FRAMES TO FINAL FINISH GRADE.

| PIPE ALLOWANCES | |
|--|----------------------|
| PIPE MATERIAL | MAX. INSIDE DIAMETER |
| REINFORCED OR PLAIN CONCRETE | 12" |
| ALL METAL PIPE | 15" |
| SOLID WALL PVC (WSDOT STD. SPEC. 9-05.12(1)) | 15" |



NOTE: THIS PLAN IS NOT A LEGAL ENGINEERING DOCUMENT BUT AN ELECTRONIC DUPLICATE. THE ORIGINAL, SIGNED BY THE ENGINEER AND APPROVED FOR PUBLICATION IS KEPT ON FILE AT THE CITY OF KENT. A COPY MAY BE OBTAINED UPON REQUEST.

| | | | |
|----------------------------|-------------|---|--|
| | | CITY OF KENT ENGINEERING DEPARTMENT | |
| | | CATCH BASIN TYPE I | |
| DESIGNED COK | SCALE NONE | STANDARD PLAN 5-1 | |
| DRAWN COK | DATE 9/2020 | | |
| CHECKED COK | ENGINEER | | |
| APPROVED <i>Chad Bierl</i> | | | |